

TURBO HYDRAMATIC 400 (3L80, M-40)

3 SPEED RWD



AUTOMATIC CHOICE



THE AUTOMATIC TRANSMISSION PARTS WAREHOUSE

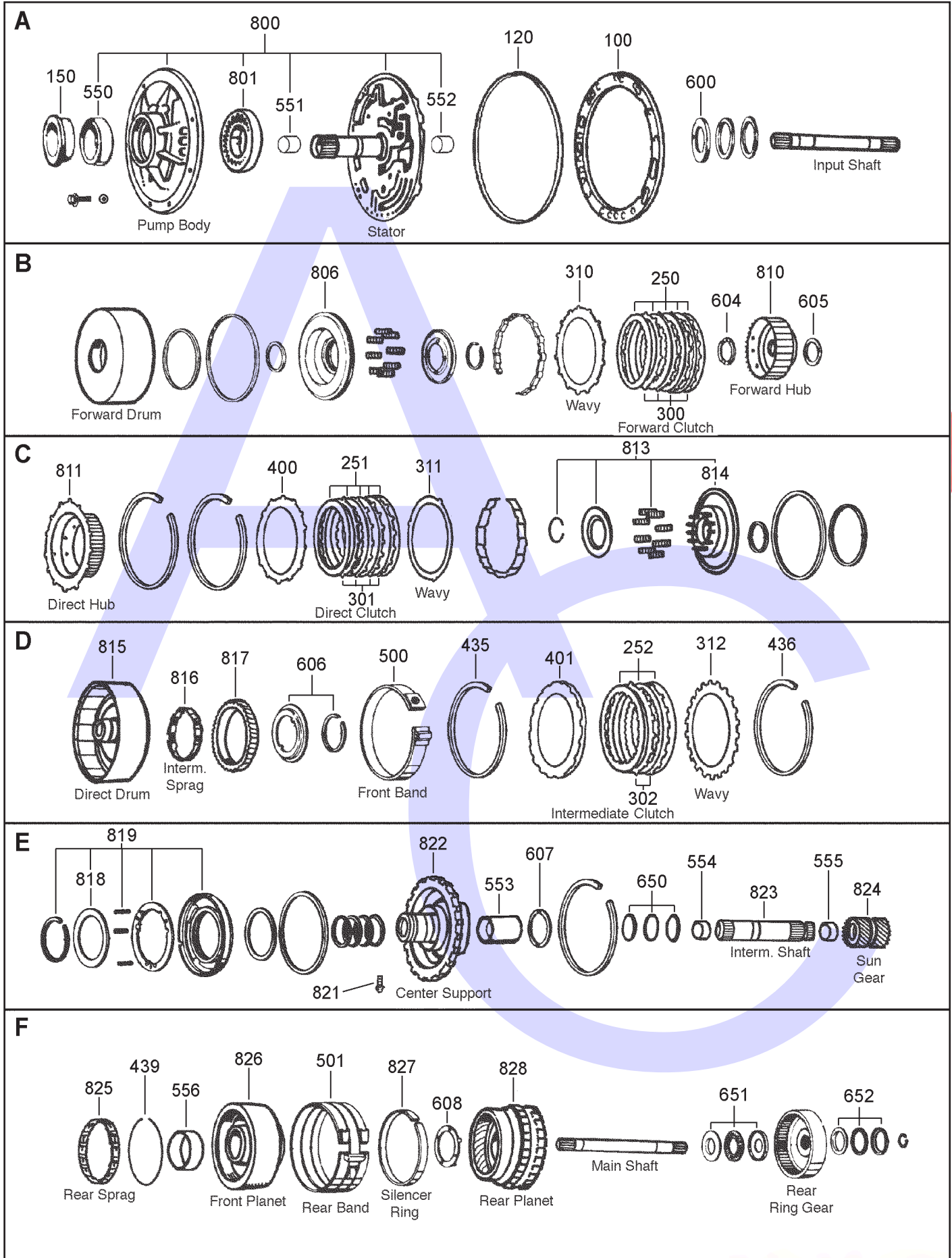

TURBO HYDRAMATIC 400 (3L80, M-40)

3 SPEED RWD



AUTOMATIC CHOICE



THE AUTOMATIC TRANSMISSION PARTS WAREHOUSE

G

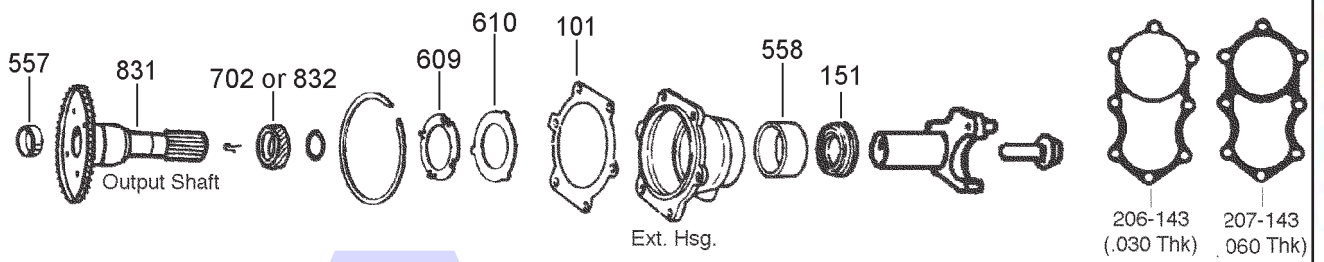

H

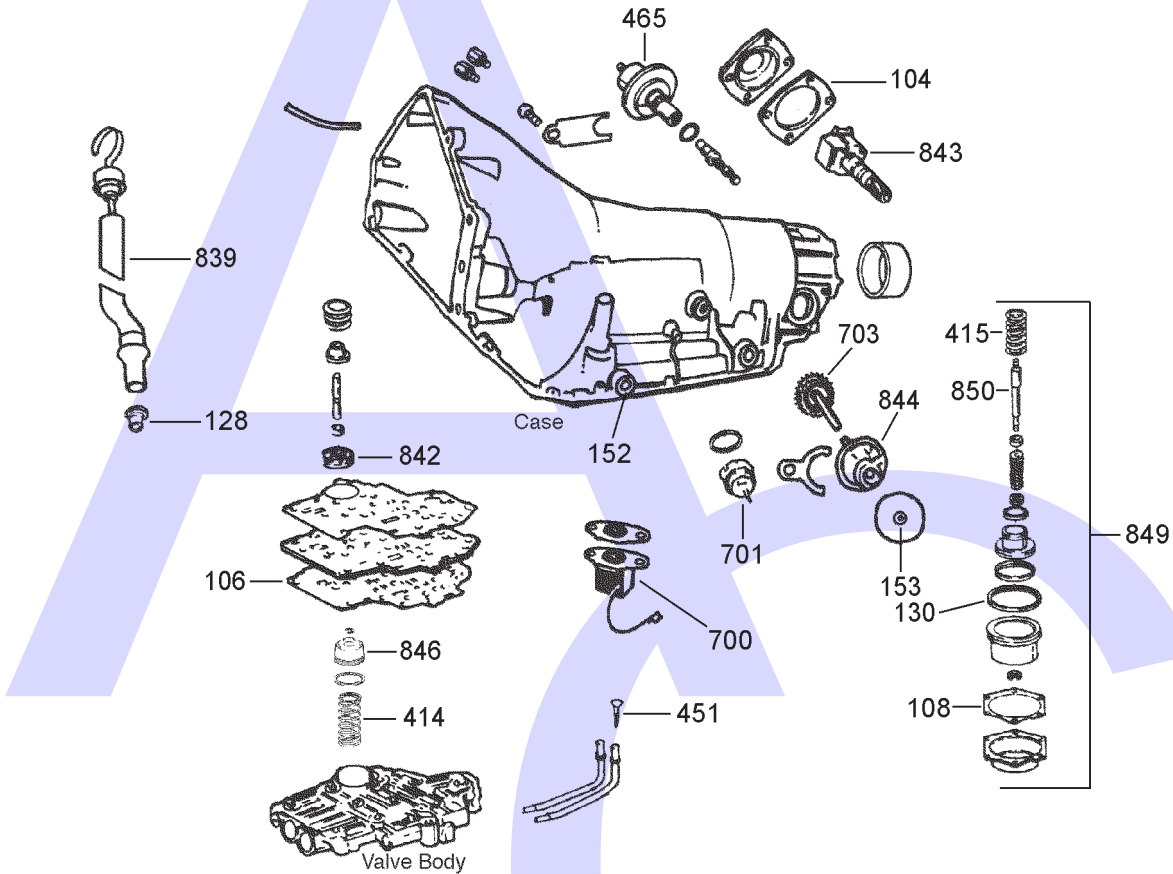

J

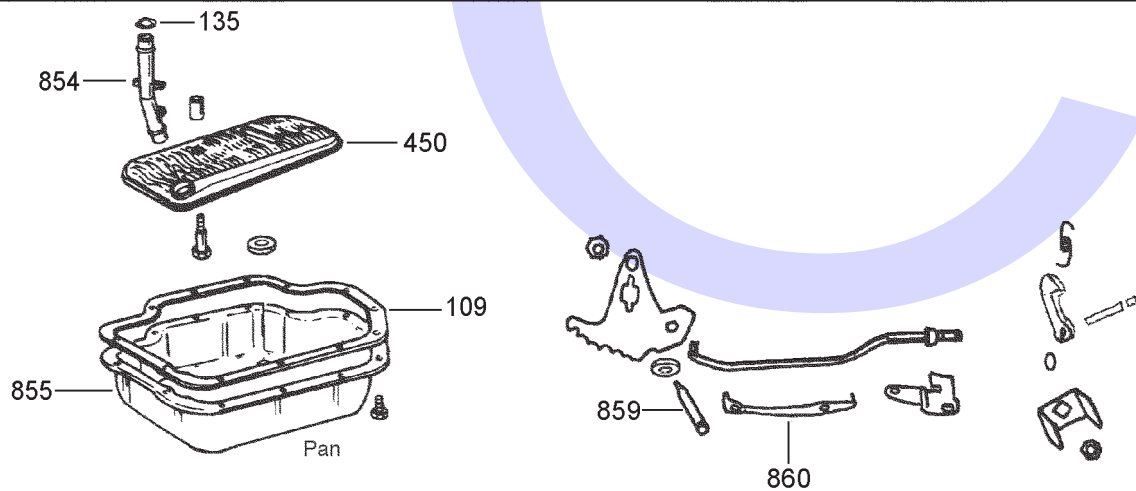

TURBO HYDRAMATIC 400 (3L80, M-40)

3 SPEED RWD



AUTOMATIC CHOICE



THE AUTOMATIC TRANSMISSION PARTS WAREHOUSE

ILL NO.	DESCRIPTION	YEARS	QTY	PART NO
KITS				
Kit	Super Overhaul Kit.....	64-98	1	TH400.SOHK01
Kit	Banner Kit (Includes Frictions) ..	64-98	1	TH400.BAK01
Kit	Overhaul Kit (Transtec).....	64-98	1	TH400.OHK01
Kit	Gasket & Rubber Kit	64-98	1	TH400.GSK01
GASKETS				
100A	Front Pump Gasket.....	64-98	1	TH400.GAS02
101G	Extension Housing Gasket.....	64-98	1	TH400.GAS03
104H	Governor Cover Gasket.....	64-98	1	TH400.GAS04
106H	Valve Body to Spacer Plate (7 Check Ball Type).....	L87-98	1	TH400.GAS05
108H	Low/Reverse Servo Cover	64-98	1	TH400.GAS06
109J	Pan Gasket TH400	64-98	1	TH400.GAS01
109J	Pan Gasket (Fibre).....	64-98	1	TH400.GAS10
RUBBER COMPONENTS				
120A	Front Pump O Ring TH400	64-98	1	TH400.SQR01
128H	Filler Tube Seal Multi Lip.....	64-98	1	TH125.LIP03
128H	Filler Tube Seal 'O' Ring (Rolls Royce)	64-98	1	TH400.OR03
130H	Seal, Rear Servo Piston.....	64-98	1	TH400.LIP01
135J	O-Ring, Filter Pick-Up Tube	64-98	1	TH400.OR02
METAL CLAD SEALS				
150A	Front Pump Seal.....	64-98	1	TH400.MCS03
151H	Ext Housing (63.53mm O.D).....	64-98	1	TH400.MCS02
151H	Ext Housing (68.60mm O.D).....	64-98	1	TH400.MCS01
151H	Ext Housing (73.15mm O.D) Motor Home	64-98	1	TH400.MCS04
152H	Selector Shaft	64-98	1	TH180.MCS03
153H	Speedo Driven Gear Shaft (With Spring).....	64-98	1	TH180.MCS04
153H	Speedo Driven Gear Shaft (Without Spring).....	64-98	1	TH180.MCS05
SEALING RINGS				
Kit	Sealing Ring (Steel 10 Rings)...	64-98	1	TH400.SRK01
Kit	Sealing Ring (Teflon).....	64-98	1	TH400.SRK02
FRICITION & STEEL KITS				
Kit	Friction & Steel, Forward Clutch (Alto Red Eagle™).....	64-98	1	TH400.CK51
Kit	Friction & Steel, Direct Clutch (Alto Red Eagle™).....	64-98	1	TH400.CK52
Kit	Friction & Steel, Intermediate Clutch (Alto Red Eagle™).....	64-98	1	TH400.CK53
FRICITION PLATES				
Kit	Friction Plate	64-98	1	TH400.FRK01
Kit	Friction Plate (Alto)	64-98	1	TH400.FRK51
Kit	Friction Plate (Alto) (High Performance).....	64-95	1	TH400.FRK61
Kit	Friction Plate (Alto) (With Heg Frictions)	64-95	1	TH400.FRK62
250B	Forward Clutch (Smooth) (150mm OD x 2.00mm x 42T) ..	64-98	5	TH400.FRP01
250B	Forward Clutch (Raybestos) (150mm OD x 2.00mm x 42T) ..	64-98	5	TH400.FRP32

ILL NO.	DESCRIPTION	YEARS	QTY	PART NO
FRICITION PLATES Cont...				
250B	Forward Clutch (Raybestos) (150mm OD x 1.57mm x 42T) ..	64-98	5	TH400.FRP31
250B	Forward Clutch (Smooth) (Alto) (150mm OD x 2.00mm x 42T) ..	64-98	5	TH400.FRP51
250B	Forward Clutch (Smooth) (Alto Red Eagle) (150mm OD x 1.52mm x 42T) ..	64-98	AR	TH400.FRP53
250B	Forward Clutch (Waffle) (150mm OD x 2.00mm x 42T) ..	64-98	5	TH400.FRP03
250B	Forward Clutch (Radial Groove) (150mm OD x 2.00mm x 42T) ..	64-98	5	TH400.FRP05
250B	Forward Clutch (Raybestos®) (Gen 2 Blue Plate Special, Race Plate) (150mm OD x 2.00mm x 42T) ..	64-90	5	TH400.FRP06
251C	Direct Clutch (Smooth) (150mm OD x 2.00mm x 42T) ..	64-98	5	TH400.FRP01
251C	Direct Clutch (Raybestos) (150mm OD x 2.00mm x 42T) ..	64-98	5	TH400.FRP32
251C	Direct Clutch (Raybestos) (150mm OD x 1.57mm x 42T) ..	64-98	5	TH400.FRP31
251C	Direct Clutch (Smooth) (Alto Red Eagle) (150mm OD x 1.52mm x 42T) ..	64-98	AR	TH400.FRP53
251C	Direct Clutch (Waffle) (150mm OD x 2.00mm x 42T) ..	64-98	5	TH400.FRP03
251C	Direct Clutch (Raybestos®) (Gen 2 Blue Plate Special, Race Plate) (150mm OD x 2.00mm x 42T) ..	64-90	5	TH400.FRP06
252D	Intermediate (Smooth Waved) (167mm OD x 2.00mm x 47T) ..	64-98	3	TH400.FRP02
252D	Intermediate (Red Eagle) (167mm OD x 1.52mm x 47T) ..	64-98	AR	TH400.FRP52
252D	Intermediate (Waffle Flat) (167mm OD x 2.00mm x 47T) ..	64-98	3	TH400.FRP04
252D	Intermediate (Raybestos®) (Gen 2 Blue Plate Special, Race Plate) (167mm OD x 2.00mm x 47T) ..	64-90	4	TH400.FRP07
STEEL PLATES				
Kit	Steel Plate Kit	64-98	1	TH400.STK01
Kit	Steel Plate Kit (Alto).....	64-98	1	TH400.STK51
Kit	Steel Plate Kit (Alto) (High Performance With Turbulator Steels)	64-95	1	TH400.STK61
300B	Forward Clutch Flat (116mm ID x 1.52mm x 12T)	64-98	4-5	TH400.STP08
300B	Forward Clutch Flat (116mm ID x 1.96mm x 12T)	64-98	4-5	TH400.STP02
300B	Forward Clutch Flat (116mm ID x 2.30mm x 12T)	64-98	AR	TH400.STP03
301C	Direct Clutch Flat (116mm ID x 1.52mm x 12T)	64-98	4-5	TH400.STP08
301C	Direct Clutch Flat (116mm ID x 1.96mm x 12T)	64-98	4-5	TH400.STP02
301C	Direct Clutch Flat (116mm ID x 2.30mm x 12T)	64-98	4-5	TH400.STP03
302D	Intermediate Clutch (127mm ID x 2.54mm x 21T)	64-98	3	TH400.STP04
310B	Forward Clutch Waved (116mm ID x 1.52mm x 12T)	64-98	1	TH400.STP06
310B	Forward Clutch Waved (Alto) (116mm ID x 1.52mm x 12T)	64-98	1	TH400.STP07
310B	Forward Clutch Dished Steel (2 Tangs).....	65-98	1	TH400.DIA01
311C	Direct Clutch Waved (116mm ID x 1.52mm x 12T)	64-98	1	TH400.STP06
311C	Direct Clutch Waved (Alto) (116mm ID x 1.52mm x 12T)	64-98	1	TH400.STP07
311C	Direct Clutch Dished Steel (2 Tangs).....	65-98	1	TH400.DIA01

TURBO HYDRAMATIC 400 (3L80E, M-40)

3 SPEED RWD



AUTOMATIC CHOICE



THE AUTOMATIC TRANSMISSION PARTS WAREHOUSE

ILL NO.	DESCRIPTION	YEARS	QTY	PART NO
STEEL PLATES Cont...				
312D	Intermediate Waved (127mm ID x 1.78mm x 21T)	64-98	1	TH400.STP05
PRESSURE PLATES				
400C	Direct Clutch	64-98	1	TH400.PP01
401D	Intermediate Clutch.....	64-98	1	TH400.PP02
SPRINGS & CIRCLIPS				
Kit	Snap Ring	64-90	1	TH400.CIR10
Kit	Snap ring.....	64-98	1	TH400.SRK03
414H	Spring, Accumulator (Yellow)	65-98	1	TH400.SPR02
415H	Spring, Rear Servo (Yellow).....	64-98	1	TH400.SPR06
435D	Circlip, Intermediate Clutch (Outer).....	91-ON	1	4L80E.CIR05
436D	Circlip, Intermediate Clutch (Inner)	91-ON	1	4L80E.CIR06
439F	Spacer Ring, Low Roller Clutch	64-98	1	TH400.RET02
FILTERS				
450J	Pan Filter.....	64-E67	1	TH400.FIL03
450J	Pan Filter.....	L67-98	1	TH400.FIL01
451H	Conical Governor Screen.....	64-98	1	TH400.FIL02
MODULATORS				
465H	Modulator Adjustable (Red Stripe).....	64-98	1	TH350.MOD01
465H	Modulator Large Black Canister (Replaced By TH350.MOD01) ..	64-98	1	TH400.MOD02
BANDS				
500D	Intermediate Overrun (Front)	64-98	1	TH400.BAN01
500D	Intermediate Overrun (Front) (Alto High Performance)	64-98	1	TH400.BAN05
501F	Low & Reverse (New)	64-98	1	TH400.BAN02
501F	Low & Reverse (Reline)	64-98	1	TH400.BAN03
501F	Low & Reverse (Kevlar®)	64-98	1	TH400.BAN06
BUSHES				
Kit	Bush Kit (Less Extension Bush)	64-98	1	TH400.BK01
Kit	Bush Kit (Inc. Extension Bush) .	64-98	1	TH400.BK02
550A	Front Pump Bush	64-98	1	TH180.BUS01
550A	Front Pump Bush (PTFE Lined) (Sonnax® Click here for Info) .	64-98	1	TH180.BUS02
551A	Stator Support Front	64-98	1	TH400.BUS07
552A	Stator Support Rear	64-98	1	TH400.BUS07
553E	Centre Support.....	64-98	1	TH400.BUS03
554E	Sungear Shaft Front.....	64-98	1	TH400.BUS07
555E	Sungear Shaft Rear	64-98	1	TH400.BUS07
556F	Planetary Carrier.....	64-98	1	TH400.BUS05
557G	Output Shaft (10.40mm Wide) ..	74-98	1	TH400.BUS06
558G	Extension Housing (50.67mm OD x25.40mm Long)	64-98	1	TH400.BUS02
558G	Extension Housing (50.67mm OD x38.10mm Long)	64-98	1	TH400.BUS04
558G	Extension Housing (45.60mm OD x31.50mm Long)	64-98	1	NLA
NI	Governor Bore Repair Sleeve (Requires Special Tool).....	64-98	AR	TH350.BUS02

ILL NO.	DESCRIPTION	YEARS	QTY	PART NO
THRUST BEARINGS & WASHERS				
Kit	Thrust Washer Kit	64-98	1	TH400.TWK01
Kit	Thrust Bearing Kit	64-98	1	TH400.TWK02
600A	Front Pump Selective Selective (2.41mm Thick)	64-98	AR	TH400.THW04
	Selective (2.69mm Thick)	64-98	AR	TH400.THW05
	Selective (2.97mm Thick)	64-98	AR	TH400.THW06
	Selective (3.25mm Thick)	64-98	AR	TH400.THW07
604B	Forward Clutch Hub to Forward Clutch Housing	64-98	1	TH400.THW08
605B	Forward Clutch Hub to Direct Clutch Housing	64-98	1	TH400.THW09
605B	Forward Clutch Hub to Direct Clutch Housing (Sonnax®) (1.98mm 5 Pack).....	64-98	1	TH400.THWK04
605B	Forward Clutch Hub to Direct Clutch Housing (Sonnax®) (2.39mm 5 Pack).....	64-98	1	TH400.THWK03
606D	Race/Retainer, Intermediate One Way Clutch (with Circlip) ...	64-98	1	TH400.THW22
607E	Center Support to Front Planet (Metal).....	64-98	1	TH400.THW10
608F	Thrust Washer, 4 Tang Plastic Front to Rear Planetary.....	64-98	1	TH400.THW12
609G	Output Shaft to Case (4 Tang) (Metal).....	64-98	1	TH400.THW15
610G	Output Shaft to Case (3 Tang) Selective (1.93mm Thick)	64-98	AR	TH400.THW16
	Selective (2.13mm Thick)	64-98	AR	TH400.THW17
	Selective (2.34mm Thick)	64-98	AR	TH400.THW18
	Selective (2.54mm Thick)	64-98	AR	TH400.THW19
	Selective (2.74mm Thick)	64-98	AR	TH400.THW20
	Selective (2.95mm Thick)	64-98	AR	TH400.THW21
610G	Case Saver (3 Tang Washer Replacement) .	64-98	1	TH400.THW23
650E	Bearing w/ Race, Center Support to Sun Gear.....	64-98	1	TH400.THW11
651F	Bearing w/ Race, Sun Gear to Rear Ring Gear.....	64-98	1	TH400.THW13
652F	Bearing w/ Race, Rear Ring Gear to Output Shaft.....	64-98	1	TH400.THW14
ELECTRICAL COMPONENTS				
700H	Detent Solenoid	64-98	1	TH400.SOL01
701H	Connector, 1 Prong (Small OD) 1964		1	TH400.ELE03
701H	Connector, 1 Prong (Large OD) 68-98		1	TH400.ELE04
701H	Connector, 2 Prong	70-82	1	TH400.ELE01
701H	Universal Connector, 4 Pin Square can be Used in Place of 2 and 3 Pin Case Connector	70-82	1	TH400.ELE02
702G	Rotor for Electronic VSS	65-98	1	TH400.ELE06
703H	Late Speed Sensor (VSS) (For Electronic Speedo)	65-98	1	TH400.ELE05
NI	Third Gear Pressure Switch (Fits on Valve Body).....	64-98	1	TH400.ELE07
VALVE BODY PARTS				
Kit	Shift Kit®.....	64-98	1	TH400.SK01
Kit	Reprogramming Kit™, Heavy Duty & Competition.....	64-98	1	TH400.SK03
Kit	Reprogramming Kit™, Competition Only, Stick Shift Full Manual Control..	64-98	1	TH400.SK02
Kit	Reverse Cushion, Corrects Harsh Reverse	64-98	1	TH400.SK04
Kit	Pressure Regulator & Boost Valve (Sonnax, Fits in Pump)	64-98	1	TH400.VA01

TURBO HYDRAMATIC 400 (3L80, M-40)

3 SPEED RWD



AUTOMATIC CHOICE

ILL NO.	DESCRIPTION	YEARS	QTY	PART NO
HARD PARTS				
Kit	Front Servo, Piston & Sleeve Kit (Sonnax®).....	64-98	1	TH400.ACC02
800A	Pump, 6 Bolt(Body Cast # 895, Stator Cast # 896).....	71-98	1	TH400.PUM01
800A	Pump, 8 Bolt(Body Cast # 895, Stator Cast # 896).....	64-98	1	TH400.PUM03
801A	Pump Gears, (18.47mm Thick) ..	64-98	1	TH400.PUM02
806B	Piston, Forward Clutch (Alloy With Spring Pockets, No Check Ball)	64-98	1	TH400.PIS03
810B	Clutch Hub, Forward Clutch.....	64-98	1	TH400.DRU04
810B	Clutch Hub, Forward Clutch (Heavy Duty) (Sonnax® Click here for Info) ..	64-98	1	TH400.DRU06
810B	Extreme Duty Forward Clutch Hub Kit (Sonnax® Click here for Info) ..	64-98	1	TH400.DRU08
811C	Clutch Hub, Direct Clutch.....	64-98	1	TH400.DRU05
813C	Piston Kit, Direct Clutch (5 Plate Aluminium).....	64-98	1	TH400.PIS05
813C	Piston Kit, Direct Clutch (6 Plate Aluminium, with Ball) ...	64-98	1	TH400.PIS07
815D	Direct (5 Clutch No Check Ball) (Smooth Cam, Sprag Clutch)....	64-98	1	TH400.DRU01
815D	Direct (6 Clutch No Check Ball) (Lug Cam, Roller Clutch)	64-98	1	TH400.DRU03
816D	Sprag, Intermediate (16 Elements).....	65-77	1	4L80E.OWC04
816D	Sprag, Intermediate (34 Elements) Heavy Duty	64-77	1	TH400.OWC03
816D	Sprag, Intermediate (8 Roller Type)	72-98	1	TH400.OWC02
817D	Race, Intermediate Sprag (Outer Race 19mm)	64-98	1	TH400.OWC04
818E	Retainer, Intermediate Brake Return Spring.....	64-98	1	TH400.RET01
819E	Piston Kit, Intermediate Clutch..	64-98	1	TH400.PIS06
821E	Bolt, Centre Support (25.77mm Long).....	64-98	1	TH400.NUT01
822E	Center Support, (Direct Drum has Lug Cam)	64-98	1	TH400.SUP01
823E	Shaft, Intermediate Sun Gear (32 Spline on Sun Gear)	64-98	1	TH400.SUN01
823E	Shaft, Intermediate Sun Gear (28 Splines on Sun Gear)	65-98	1	4L80E.SUN01
824E	Sun Gear, Angled Teeth (32 Spline Inside)	64-98	1	TH400.SUN02
824E	Sun Gear, Angled Teeth (28 Spline Inside)	64-98	1	TH400.SUN04
824E	Sun Gear, Straight Teeth (32 Spline Inside)	64-98	1	TH400.SUN03
825F	Sprag, Low Clutch Roller	64-98	1	TH400.OWC01
826F	Front Planetary (Angled Teeth) (Direct Drum has Lug Cam) (Roller Style Sprag).....	67-98	1	TH400.PL01
826F	Front Planetary, Straight Teeth ..	67-98	1	TH400.PL03
826F	Front Planetary, Angled Teeth (No Tab Roller Sprag)	67-98	1	TH400.PL04
827F	Silencer Ring, Output Carrier (4.50mm).....	69-80	1	TH400.SP01
828F	Rear Planetary (Angled Teeth) (12.70mm Parking Lugs).....	64-98	1	TH400.PL02
828F	Rear Planetary, 4 Gear Angled Teeth (With Reluctor Ring).....	91-98	1	TH400.PL05
831G	Output Shaft (Jaguar) (Bolt on Flange)	64-98	1	TH400.SH02
832G	Steel Drive Gear, Speedometer (21 Starts)	64-ON	1	TH400.GE03
839H	Filler Tube & Dip Stick, GM Universal Fitz All (Teckpak).....	64-98	1	TH400.DIP01

ILL NO.	DESCRIPTION	YEARS	QTY	PART NO
HARD PARTS Cont...				
842H	Piston, Front Servo (Used)	64-98	1	TH400.PIS02
843H	Governor Assembly Complete ..	64-98	1	TH400.GOV02
NI	Governor Gear Repair Kit	64-98	1	TH400.GOV01
844H	Speed-O Housing, Aluminum (34-39 T Gear Type).....	64-98	1	TH400.GE01
846H	Accumulator Piston	64-98	1	TH400.PIS01
849H	Rear Servo Assembly (With Raised Hump on Piston)..	64-98	1	TH400.PIS04
849H	Rear Servo Assembly (No Raised Hump on Piston)	64-98	1	TH400.PIS08
850H	Pin, Rear Servo. (86.74mm Long).....	64-98	AR	TH400.SER01
	(88.16mm Long).....	64-98	AR	TH400.SER02
854J	Filter Extension Tube For Deep Pan.....	65-98	1	TH400.TU02
855J	Oil Pan (Shallow Chrome)	65-98	1	TH400.PAN01
855J	Oil Pan (Deep)	65-98	1	TH400.PAN02
859J	Manual Shaft, Short Version (Sonnax® Click here for info)....	64-98	1	4L80E.VA18
860J	Detent Roller & Spring	65-98	1	TH400.SP05
TOOLS & MANUALS				
NI	ATSG Rebuild Manual	64-98		TH400.MAN01
Click here to view special tools for this transmission				



THE AUTOMATIC TRANSMISSION PARTS WAREHOUSE