

Aisin Warner VF2AM, VF2BM Chain Drive

3.0Ltr, 4.2Ltr Diesel A/T Landcruiser, 4-Runner, Tacoma 1993>
(2 Speed Part Time, Electronic or Mechanical Shift)



AUTOMATIC CHOICE



THE AUTOMATIC TRANSMISSION PARTS WAREHOUSE

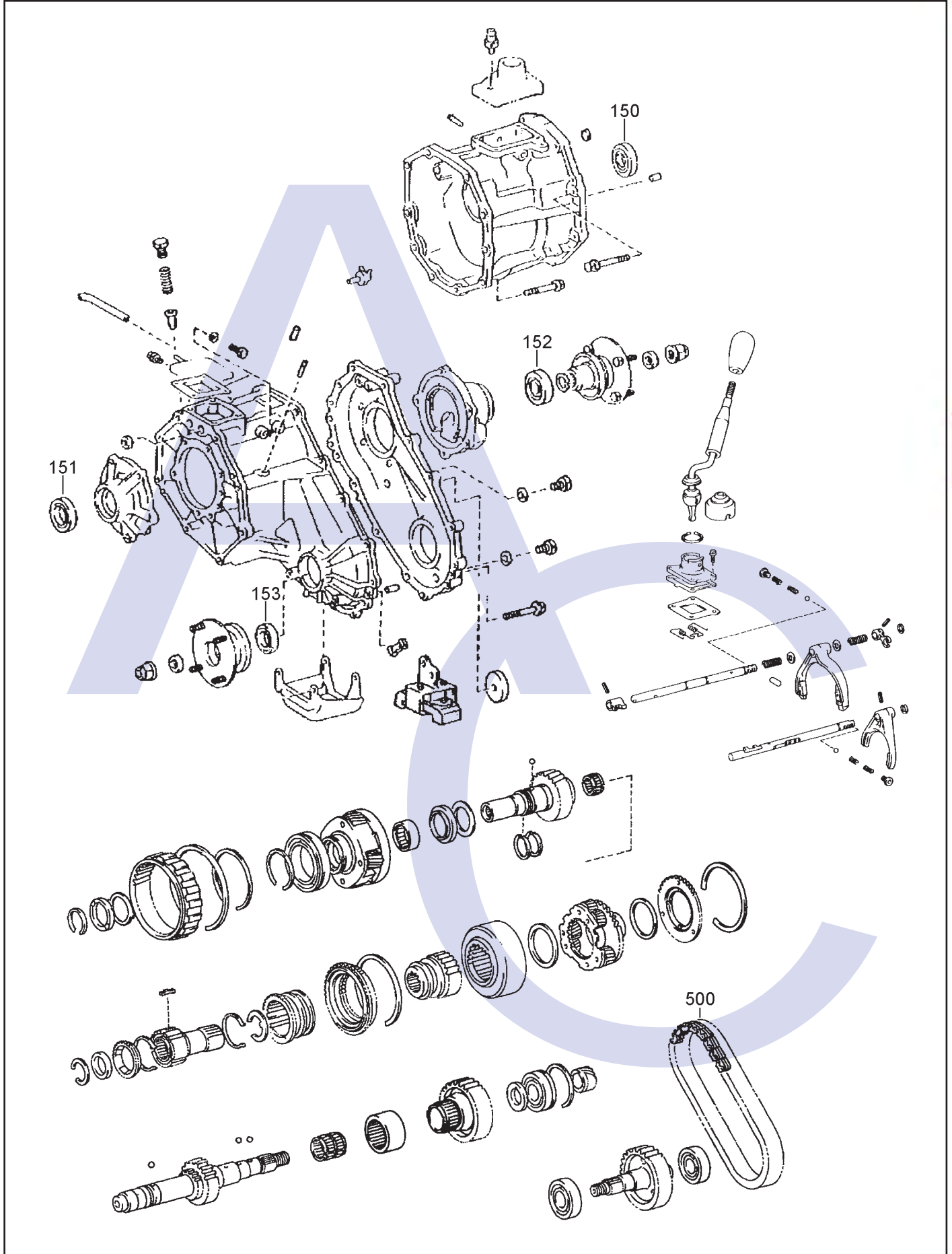

Aisin Warner VF2AM, VF2BM Chain Drive 3.0Ltr, 4.2Ltr Diesel A/T Landcruiser, 4-Runner, Tacoma 1993> (2 Speed Part Time, Electronic or Mechanical Shift)



**A
U
T
O
M
A
T
I
C
C
H
O
I
C
E**



**T
H
E

A
U
T
O
M
A
T
I
C

T
R
A
N
S
M
I
S
S
I
O
N

P
A
R
T
S

W
A
R
E
H
O
U
S
E**

ILL NO.	DESCRIPTION	YEARS	QTY	PART NO
MASTER OVERHAUL KITS				
OVERHAUL GASKET AND SEAL KITS				
GASKET & RUBBER COMPONENTS				
METAL CLAD SEALS				
150	Adaptor Case to Transfer Unit (Land Cruiser).....	93-ON	1	YAW.MCS01
151	Transfer Unit Input (Land Cruiser).....	93-ON	1	YAW.MCS02
152	Transfer Unit Rear Output (Land Cruiser).....	93-ON	1	YAW.MCS03
153	Transfer Unit Front Output (Land Cruiser).....	93-ON	1	YAW.MCS04
BUSHINGS, BEARINGS & WASHERS				
DRIVE CHAINS				
500	Drive Chain 74 Pitch (11.112mm Pitch x 31.75 Wide)	4/93-ON	1	YAW.CH01
ELECTRICAL COMPONENTS				
HARD PARTS				
MOUNTINGS				
TRANSFER CASE ASSY'S				
TOOLS & MANUALS				

ILL NO.	DESCRIPTION	YEARS	QTY	PART NO