

NISSAN RL4F02A, RE4F02A/V

4 SPEED FWD (Electronic & Hydraulic Control)



AUTOMATIC CHOICE



THE AUTOMATIC TRANSMISSION PARTS WAREHOUSE

A

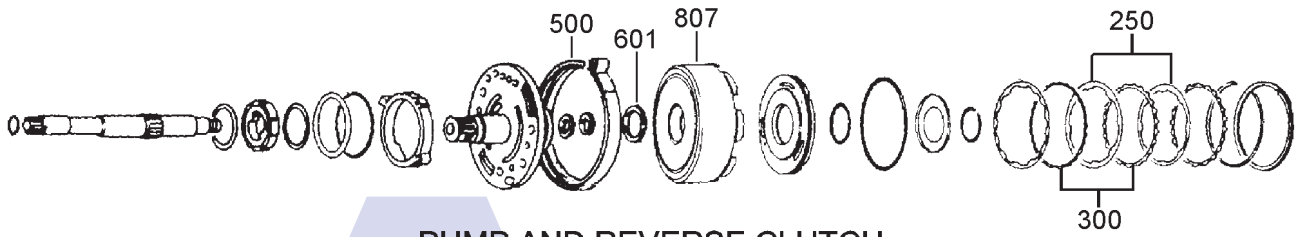

PUMP AND REVERSE CLUTCH

B

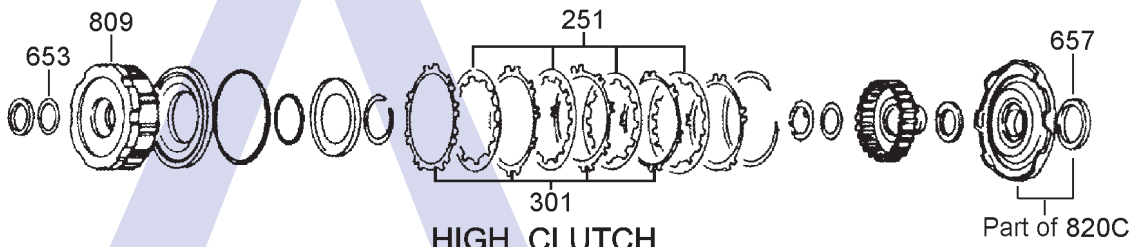

HIGH CLUTCH

C

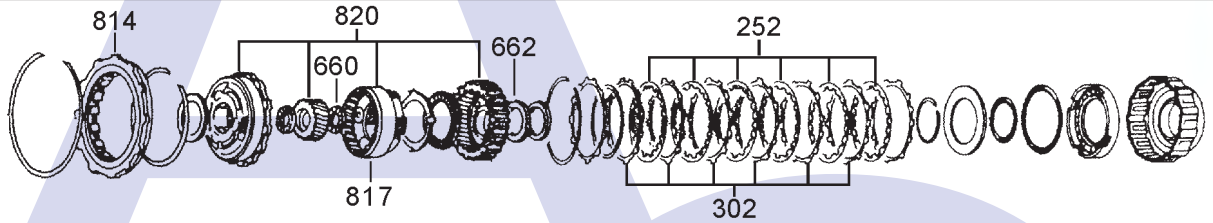

PLANET SET AND LOW CLUTCH

D

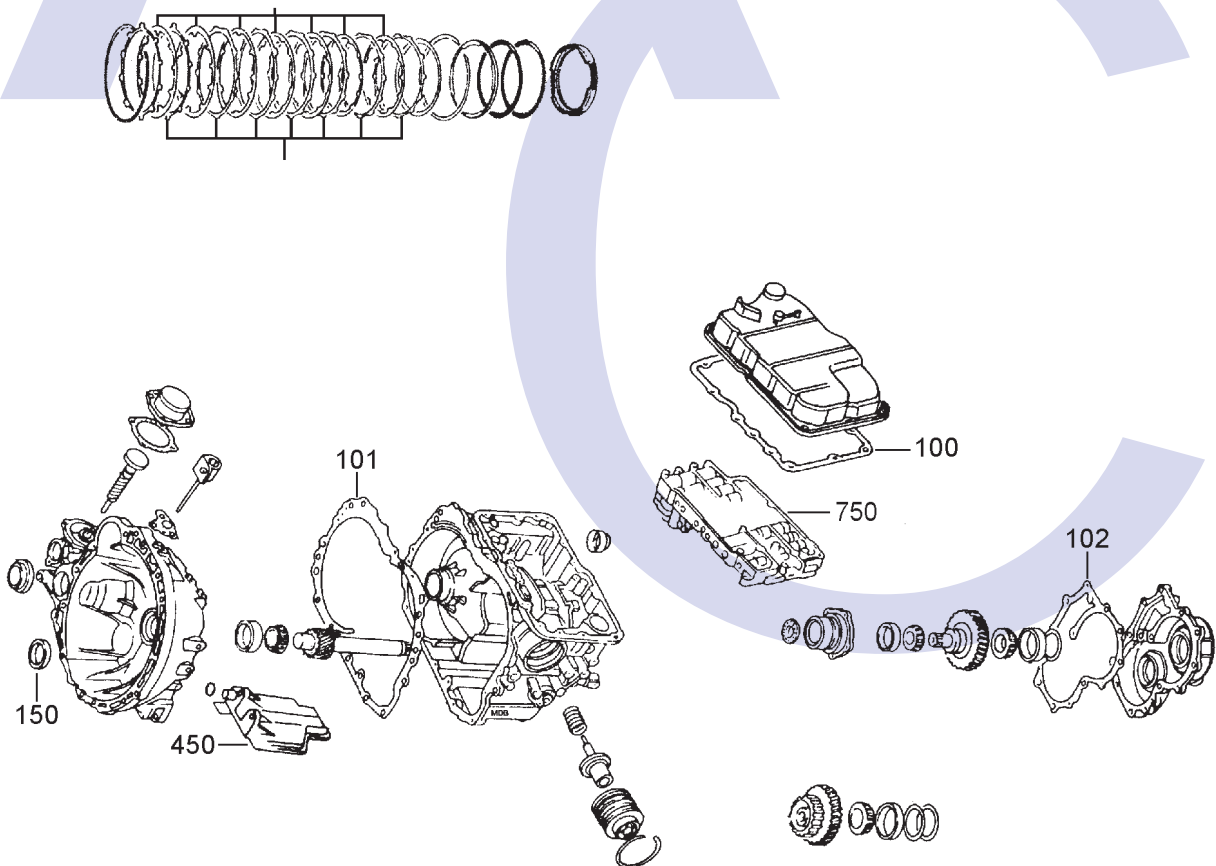

LOW REVERSE CLUTCH AND CASE

NISSAN RL4F02A, RE4F02A/V 4 SPEED FWD (Electronic & Hydraulic Control)



AUTOMATIC CHOICE



THE AUTOMATIC TRANSMISSION PARTS WAREHOUSE

ILL NO.	DESCRIPTION	YEARS	QTY	PART NO
KITS				
Kit	Overhaul Kit RL4F02A (Transtec).....	85-7/88	1	RL4.OHK01
Kit	Overhaul Kit RL4F02A (Precision).....	85-7/88	1	RL4.OHK52
Kit	Overhaul Kit RL4F02A (Nissan) (Transtec)	7/88-ON	1	RL4.OHK05
Kit	Overhaul Kit RE4F02A/V (Maxima) (Transtec).....	89-94	1	RL4.OHK02
Kit	Overhaul Kit RE4F02A/V (Maxima) (Precision).....	89-94	1	RL4.OHK54
Kit	Gasket & Rubber Kit RL4F02A.....	85-ON	1	RL4.GSK01
Kit	Gasket & Rubber Kit RE4F02A Maxima	89-ON	1	RL4.GSK02
GASKETS				
100D	Valve Body Cover	85-ON	1	RL4.GAS01
101D	Case to Case Gasket.....	85-ON	1	RL4.GAS03
102D	Side Cover Gasket.....	85-ON	1	RL4.GAS02
NI	Upper V. Body Gasket Small (RL4F02A)	83-85	1	RL4.GAS05
NI	Upper V. Body Gasket Large (RL4F02A)	83-85	1	RL4.GAS06
NI	Lower V. Body Gasket Small (RL4F02A)	83-85	1	RL4.GAS07
NI	Lower V. Body Gasket Large (RL4F02A)	83-85	1	RL4.GAS08
NI	Upper V. Body Gasket Small (RL4F02A)	85-6/88	1	RL4.GAS16
NI	Lower V. Body Gasket Large (RL4F02A)	85-6/88	1	RL4.GAS17
NI	Lower V. Body Gasket Small (RL4F02A)	85-6/88	1	RL4.GAS18
NI	Upper V. Body Gasket Large (RL4F02A)	85-6/88	1	RL4.GAS20
NI	Upper V. Body Gasket Small (RL4F02A)	7/88-ON	1	RL4.GAS13
NI	Lower V. Body Gasket Large (RL4F02A)	7/88-ON	1	RL4.GAS14
NI	Upper V. Body Gasket Large (RL4F02A)	7/88-ON	1	RL4.GAS15
NI	Lower V. Body Gasket Small (RL4F02A)	7/88-ON	1	RL4.GAS19
NI	Lower V. Body Gasket Large (RE4F02A Maxima).....	85-ON	1	RL4.GAS09
NI	Upper V. Body Gasket Large (RE4F02A Maxima).....	85-ON	1	RL4.GAS10
NI	Upper V. Body Gasket Small (RE4F02A Maxima).....	85-ON	1	RL4.GAS11
NI	Lower V. Body Gasket Small (RE4F02A Maxima).....	85-ON	1	RL4.GAS12
Kit	Valve Body Gasket Kit Maxima	89-ON	1	RL4.GK02
RUBBER COMPONENTS				
Kit	Servo Seal Kit	85-ON	1	RL4.ORK01
METAL CLAD SEALS				
150D	Converter Seal.....	85-ON	1	RL4.MCS01

ILL NO.	DESCRIPTION	YEARS	QTY	PART NO
SEALING RINGS				
FRICITION PLATES				
Kit	Friction Plate (RE4F02A)	89-94	1	RL4.FRK01
Kit	Friction Plate (Alto) (RL4F02A) (Bluebird/Maxima).....	85 Only	1	RL4.FRK53
Kit	Friction Plate (Alto) (RL4F02A) (Bluebird/Maxima).....	86-88	1	RL4.FRK54
Kit	Friction Plate (Alto) (RL4F02A) (Stanza)	86-89	1	RL4.FRK55
Kit	Friction Plate (Alto) (RL4F02A) (Stanza Combo Kit).....	85-89	1	RL4.FRK57
Kit	Friction Plate (Alto) (RL4F02A) (Pulsar)	87-90	1	RL4.FRK56
Kit	Friction Plate (Alto) (RE4F02A) (Maxima)	89-94	1	RE4.FRK53
Kit	Friction Plate (Alto) (RE4F02A) (Stanza)	90-92	1	RE4.FRK54
250A	Reverse Input (147mm OD x 2.00mm x 8T)	85-89	2	RL4.FRP03
250A	Reverse Input (Alto) (150mm OD x 2.00mm x 8T)	85-89	2	RL4.FRP59
250A	Reverse Input (150mm OD x 2.00mm x 34T) ..	87-94	2	RL4.FRP09
251B	High Square Teeth (128mm OD x 1.60mm x 30T) ..	85	3	RL4.FRP07
251B	High Square Teeth (Alto) (128mm OD x 1.60mm x 30T) ..	85	3	RL4.FRP58
251B	High Square Teeth (128mm OD x 2.00mm x 30T) ..	85	3	RL4.FRP05
251B	High Shark Tooth (Maxima) (128mm OD x 1.60mm x 30T) ..	85-94	4	RL4.FRP02
251B	High Shark Tooth (128mm OD x 2.00mm x 30T) ..	85-94	3	RL4.FRP06
251B	High Wide Tooth (Aftermarket) (132mm OD x 1.60mm x 30T) ..	87-94	4	RL4.FRP08
251B	High Wide Tooth (OEM) (132mm OD x 1.60mm x 30T) ..	87-94	4	RL4.FRP18
252C	Low Clutch (144mm OD x 2.00mm x 30T) ..	85-94	4-6	RL4.FRP01
253D	Low & Reverse (183mm OD x 2.00mm x 12T) ..	85-94	5-7	RL4.FRP04
253D	Low & Reverse (Alto) (183mm OD x 2.00mm x 12T) ..	85-94	5-7	RL4.FRP57
STEEL PLATES				
Kit	Steel Plate (RE4F02A).....	89-94	1	RL4.STK01
Kit	Steel Plate (Alto) (RL4F02A) (Bluebird/Maxima).....	85 Only	1	RL4.STK53
Kit	Steel Plate (Alto) (RL4F02A) (Bluebird/Maxima).....	86-88	1	RL4.STK54
Kit	Steel Plate (Alto) (RL4F02A) (Stanza Combo Kit).....	85-89	1	RL4.STK55
Kit	Steel Plate (Alto) (RL4F02A) (Pulsar)	87-90	1	RL4.STK56
Kit	Steel Plate (Alto) (RE4F02A) (Maxima)	89-94	1	RE4.STK53
Kit	Steel Plate (Alto) (RE4F02A) (Stanza)	90-92	1	RE4.STK54
300A	Reverse Input Shark Tooth (136mm ID x 2.00mm x 30T)	85-94	2	RL4.STP03
300A	Reverse Input Square Tooth (136mm ID x 2.00mm x 30T)	85-94	2-3	RL4.STP09

NISSAN RL4F02A, RE4F02A/V

4 SPEED FWD (Electronic & Hydraulic Control)



AUTOMATIC CHOICE



THE AUTOMATIC TRANSMISSION PARTS WAREHOUSE

ILL NO.	DESCRIPTION	YEARS	QTY	PART NO
STEEL PLATES Cont...				
301B	High Cl;utch (Maxima) (112mm ID x 1.40mm x 24T)	87-94	7	RL4.STP03
301B	High Cl;utch (112mm ID x 1.80mm x 24T)	85-88	7	RL4.STP01
301B	High Cl;utch (112mm ID x 2.00mm x 24T)	85-88	1-5	RL4.STP02
301B	High Cl;utch (112mm ID x 2.70mm x 24T)	85-89	3	RL4.STP16
301B	High Cl;utch (112mm ID x 3.00mm x 24T)	85	3	RL4.STP12
301B	High Clutch (112mm ID x 1.70mm x 27T)	89-8/89	1	RL4.STP13
301B	High Clutch (112mm ID x 2.00mm x 27T)	8/89-94	1	RL4.STP11
301B	High Clutch (112mm ID x 2.40mm x 27T)	90-94	4	RL4.STP15
301B	High Clutch (112mm ID x 3.00mm x 27T)	87-94	3	RL4.STP10
302C	Low Clutch (123mm ID x 2.00mm x 12T)	85-94	5-7	RL4.STP06
303D	Low & Reverse (165mm ID x 2.00mm x 12T)	85-94	5-7	RL4.STP07
PRESSURE PLATES				
SPRINGS & CIRCLIPS				
FILTERS				
450D	Filter	85-ON	1	RL4.FIL01
BANDS				
500A	Band.....	85-ON	1	RL4.BAN01
500A	Band (Borg Warner).....	85-ON	1	RL4.BAN02
BUSHINGS				
Kit	Bush Kit.....	85-ON	1	RL4.BK01
NI	Converter Bush.....	85-ON	1	RL4.BUS01
NI	Pump Cover (Front)	85-ON	1	RL4.BUS02
NI	Pump Stator (Centre).....	85-ON	1	RL4.BUS03
NI	Reverse Input Drum.....	85-ON	1	RL4.BUS04
THRUST WASHERS & BEARINGS				
Kit	Planetary Bearing Kit	85-94	1	RL4.TWK02
601A	Thrust Washer Pump - Rev Input (Sel 0.89mm Thick Plastic)	85-94	AR	RL4.THW01
601A	Thrust Washer Pump - Rev Input (Sel 1.00mm Thick Plastic)	85-94	AR	RL4.THW02
601A	Thrust Washer Pump - Rev Input (Sel 1.30mm Thick Plastic)	85-94	AR	RL4.THW03
601A	Thrust Washer Pump - Rev Input (Sel 1.70mm Thick Plastic)	85-94	AR	RL4.THW04

ILL NO.	DESCRIPTION	YEARS	QTY	PART NO
THRUST WASHERS & BEARINGS Cont...				
601A	Thrust Washer Pump - Rev Input (Sel 1.93mm Thick Plastic)	85-94	AR	RL4.THW05
653B	Race Pump to High Drum (Sel 1.60mm Thick 3 Tang)	85-94	AR	RL4.THW10
653B	Race Pump to High Drum (Sel 1.78mm Thick 3 Tang)	85-94	AR	RL4.THW11
653B	Race Pump to High Drum (Sel 2.00mm Thick 3 Tang)	85-94	AR	RL4.THW112
657B	Race Sun Shell to Planet.....	85-94	1	RL4.THW07
660C	Bearing Sun Gear to Planetary ..	85-94	1	RL4.THW13
662C	Race Rear Ring Gear to Case ..	85-94	1	RL4.THW06
ELECTRICAL COMPONENTS				
NI	Solenoid Block RE4F02A Maxima	89-ON	1	RL4.SOL01
NI	EPC Solenoid.....	89-94	1	RL4.SOL02
VALVE BODY PARTS				
750D	Valve Body RL4F02A (Rebuilt) ..	85-94	1	RL4.VB01
750D	Valve Body RE4F02A (Rebuilt) ..	85-94	1	RL4.VB02
NI	Boost Valve Sleeve	85-94	1	RL4.SL01
HARD PARTS				
807A	Reverse Input Drum (Cast)	85-94	1	RL4.DRU01
807A	Reverse Input Drum (Steel)	85-94	1	RL4.DRU02
809B	High Drum 24 Tooth	85-ON	1	RL4.DRU03
809B	High Drum 27 Tooth	85-ON	1	RL4.DRU04
814C	Low Roller Clutch.....	85-ON	1	RL4.OWC01
817C	Rear Planetary Assembly.....	85-ON	1	RL4.PL06
820C	Planetary Package (4 Cylinder Rebuilt)	85-ON	1	RL4.PL03
820C	Planetary Package (6 Cylinder Maxima Rebuilt).....	89-ON	1	RL4.PL05
SPECIAL ITEMS				
TOOLS & MANUALS				
NI	ATSG Rebuild Manual (RL4F02A)	All		RL4.MAN01
NI	ATSG Rebuild Manual (RE4F02A Maxima).....	All		RL4.MAN02