

# HYUNDAI A4AF3, A4BF3 (Accent 2000-2007, Matrix 2003 >) 4 SPEED FWD With Lock Up (Electronic Control)



AUTOMATIC CHOICE



THE AUTOMATIC TRANSMISSION PARTS WAREHOUSE

A

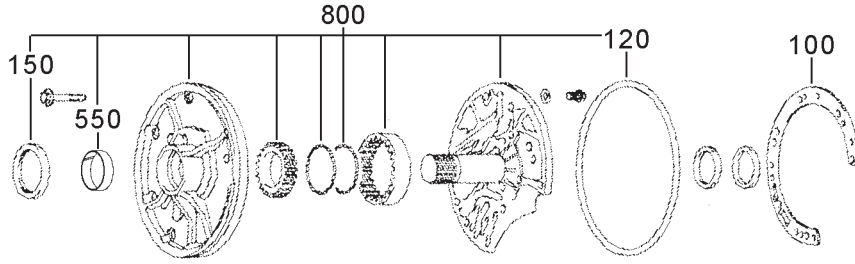

Oil Pump Assembly

B

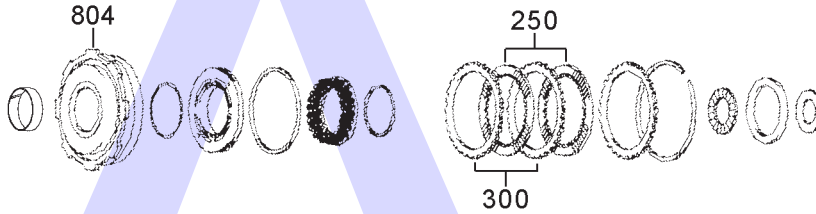

Direct Clutch Assembly

C

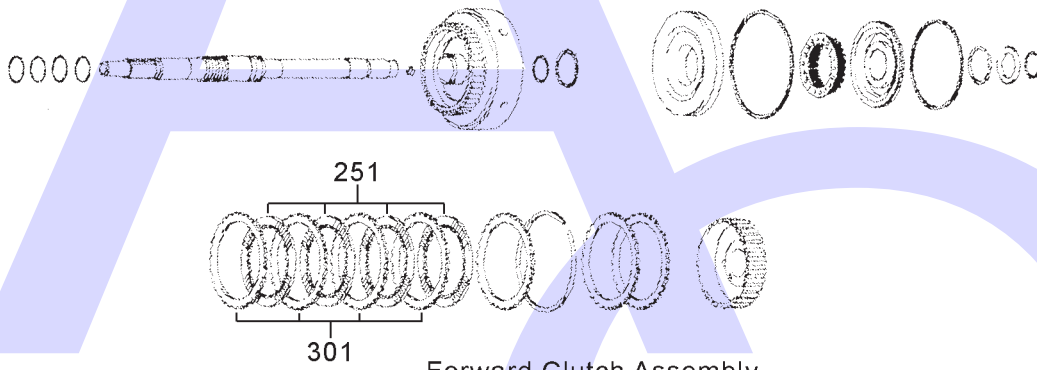

Forward Clutch Assembly

D

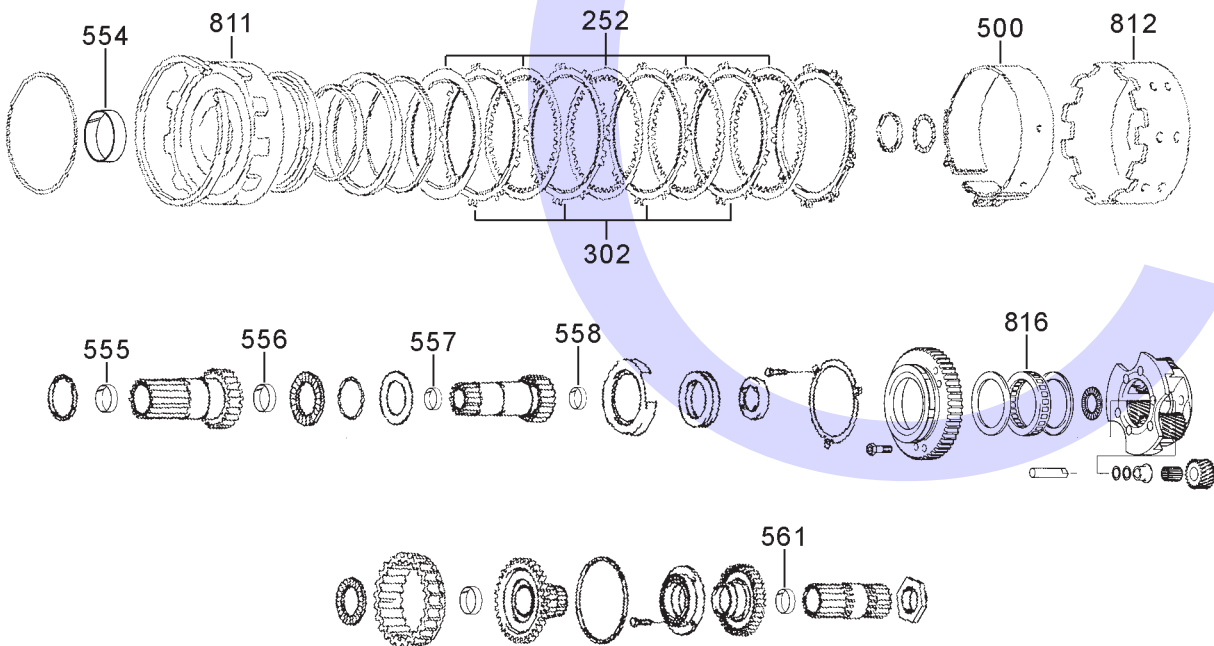

Low/Reverse Brake & Planetary Assemblies

# HYUNDAI A4AF3, A4BF3 (Accent 2000-2007, Matrix 2003 >) 4 SPEED FWD With Lock Up (Electronic Control)



AUTOMATIC CHOICE



THE AUTOMATIC TRANSMISSION PARTS WAREHOUSE

E

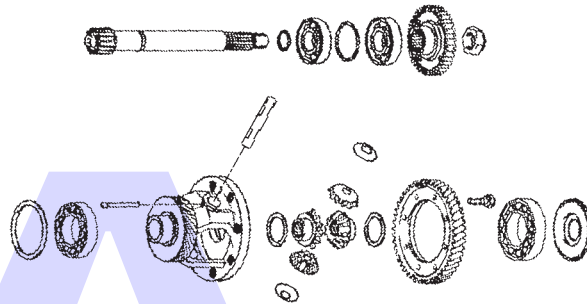

Transfer Shaft & Differential Assembly

F

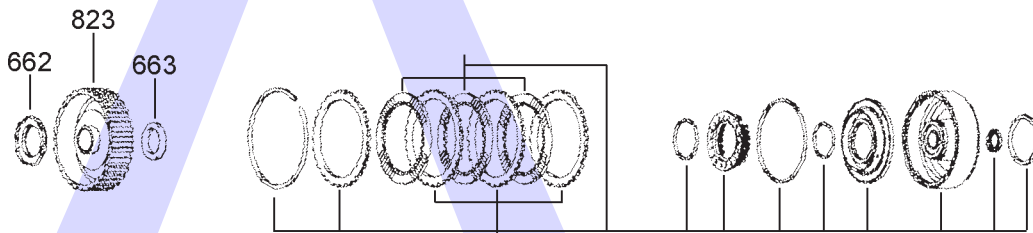

End Clutch/Overdrive Clutch Assembly

G

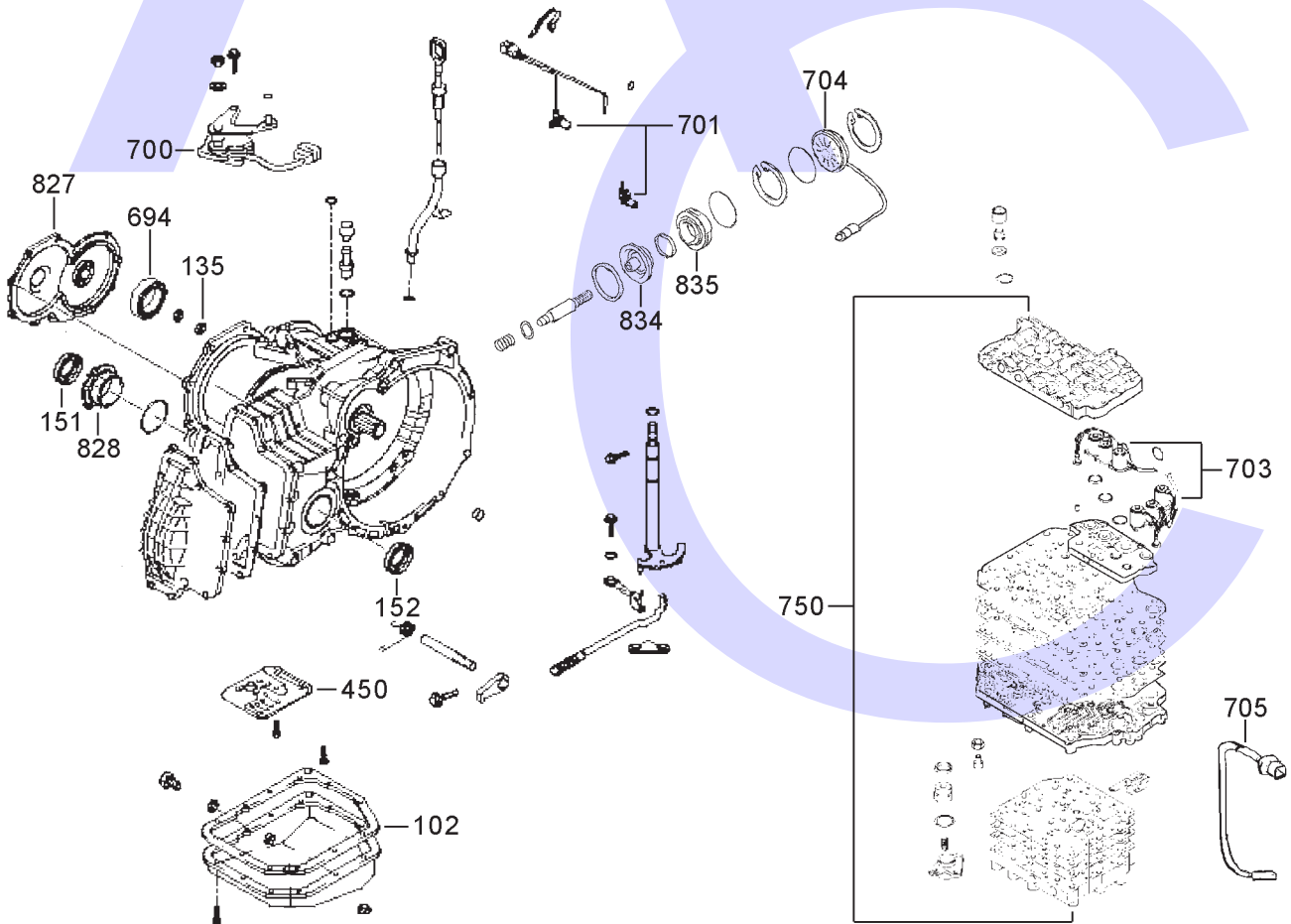

Main Case, Oil Pan, Filter, Valve Body & External Components

# HYUNDAI A4AF3, A4BF3 (Accent 2000-2007, Matrix 2003 >) 4 SPEED FWD With Lock Up (Electronic Control)



AUTOMATIC CHOICE



THE AUTOMATIC TRANSMISSION PARTS WAREHOUSE

ILL NO.	DESCRIPTION	YEARS	QTY	PART NO
<b>KITS</b>				
Kit	Overhaul A4AF3/A4BF3 (Transtec) (6 Solenoids).....	00-ON	1	<b>KM177.OHK08</b>
<b>GASKETS</b>				
100A	Pump Gasket .....	00-ON	1	<b>KM177.GAS04</b>
102G	Pan Gasket .....	00-ON	1	<b>KM177.GAS05</b>
NI	Spacer Plate Valve Body Upper With Bonded Gasket (Getz) .....	00-ON	1	<b>KM177.SP01</b>
NI	Spacer Plate Valve Body Lower With Bonded Gasket (Getz) .....	00-ON	1	<b>KM177.SP02</b>
<b>RUBBER COMPONENTS</b>				
120A	Pump O Ring .....	00-ON	1	<b>KM170.OR01</b>
135G	'O' Ring, End Cover to Case .....	00-ON	1	<b>KM177.OR01</b>
<b>METAL CLAD SEALS</b>				
150A	Front Pump Seal .....	00-ON	1	<b>KM170.MCS01</b>
151E	Drive Shaft Seal (Left Hand).....	00-ON	1	<b>KM170.MCS02</b>
152E	Drive Shaft Seal (Right Hand)...	00-ON	1	<b>KM170.MCS02</b>
<b>MOULDED PISTONS</b>				
<b>SEALING RINGS</b>				
Kit	Sealing Ring Kit .....	00-ON	1	<b>KM177.SRK02</b>
<b>FRICTION PLATES</b>				
250A	Direct Friction (127 x 38T x 1.70mm Thick) .....	00-ON	4	<b>KM170.FRP12</b>
250A	Direct Friction (127 O.D. x 104 I.D. x 38T x 1.90mm Thick) .....	00-ON	4	<b>KM170.FRP04</b>
251B	Forward Friction (127 x 38T x 1.70mm Thick) .....	00-ON	4	<b>KM170.FRP12</b>
2252C	Low/ Rev Friction (152 O.D. x 51T x 1.85mm) .....	93-ON	6	<b>KM170.FRP05</b>
253D	Overdrive Friction (Alto) (123mm x 36T x 1.65mm).....	00-ON	3	<b>KM170.FRP13</b>
<b>Check sizes before ordering as variations may exist</b>				
<b>STEEL PLATES</b>				
300A	Direct Steel (104.4 I.D. x 3.00mm x24T) .....	00-ON	3	<b>KM170.STP06</b>
301B	Forward Steel (104.4 I.D. x 2.00mm x 24T) .....	00-ON	5	<b>KM170.STP23</b>
302C	Low & Reverse Brake (134mm ID x 1.00mm x 20T) ....	00-ON	5	<b>KM170.STP15</b>
302C	Low & Reverse Brake (134mm ID x 1.08mm x 20T) ....	00-ON	5	<b>KM170.STP16</b>

ILL NO.	DESCRIPTION	YEARS	QTY	PART NO
<b>STEEL PLATES Cont...</b>				
303D	Overdrive (95.80mm ID x 4.00mm x 25T) .	00-ON	3-4	<b>KM170.STP20</b>
<b>Check sizes before ordering as variations may exist</b>				
<b>PRESSURE PLATES</b>				
403D	Low/Rev Brake (20 Teeth).....	00-ON	1	<b>KM170.PP04</b>
<b>SPRINGS &amp; CIRCLIPS</b>				
<b>FILTERS</b>				
450E	Pan Filter.....	00-ON	1	<b>KM177.FIL02</b>
<b>BANDS</b>				
500C	Band (44mm Wide).....	00-ON	1	<b>KM177.BAN01</b>
<b>BUSHINGS</b>				
550A	Converter to Pump.....	00-ON	1	<b>KM170.BUS01</b>
554D	Centre Support (Narrow) (42.926mm ID).....	00-ON	1	<b>KM175.BUS05</b>
555D	Reverse Sun Gear (Front) (28.00mm ID).....	00-ON	1	<b>KM175.BUS04</b>
556D	Reverse Sun Gear (Rear) (28.00mm ID).....	00-ON	1	<b>KM175.BUS04</b>
557D	Forward Sungear Front (20.57mm ID).....	00-ON	1	<b>KM175.BUS03</b>
558D	Forward Sungear Rear (20.57mm ID).....	00-ON	1	<b>KM175.BUS03</b>
561D	Overdrive Shaft (20.57mm ID).....	00-ON	1	<b>KM175.BUS03</b>
<b>THRUST WASHERS &amp; BEARINGS</b>				
600A	Thrust Washer Pump to Dir Clutch Drum Selective (1.80mm).....	00-ON	AR	<b>KM170.THW03</b>
	(2.20mm).....	00-ON	AR	<b>KM170.THW02</b>
	(2.60mm).....	00-ON	AR	<b>KM170.THW01</b>
	(3.00mm).....	00-ON	AR	<b>KM170.THW04</b>
662F	Radial Bearing OD Hub (Front)	00-ON	1	<b>KM177.TOR01</b>
663F	Thrust Washer, OD Hub (Rear)	00-ON	1	<b>KM177.THW01</b>
694G	Bearing, OD Clutch to End Cover.....	00-ON	1	<b>KM177.BE01</b>
<b>ELECTRICAL COMPONENTS</b>				
700G	Range Switch (Getz OE).....	00-ON	1	<b>KM177.INH01</b>
701G	Speed Sensors, Input & Output (Red Tape, Wires are 39.37cm and 20.32cm Long) .....	00-ON	1	<b>KM177.ELE02</b>
701G	Speed Sensors, Input & Output (OE) (Hyundai Getz).....	00-ON	1	<b>KM177.ELE05</b>

